

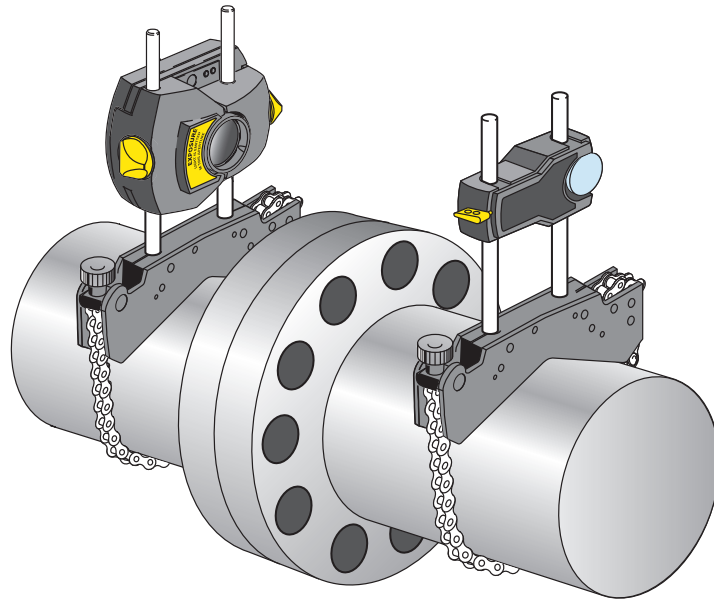

FLUKE®

831 Laser Alignment Tool



PN 5346772 August, 2022
©2022 Fluke Corporation, All Rights Reserved

1.800.561.8187

www.**itm**.com

information@itm.com

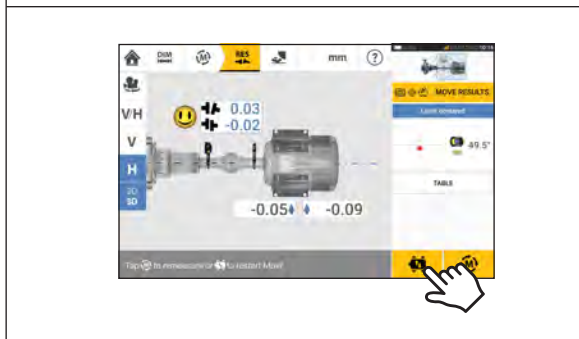
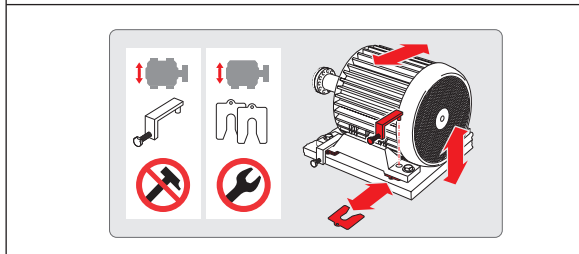
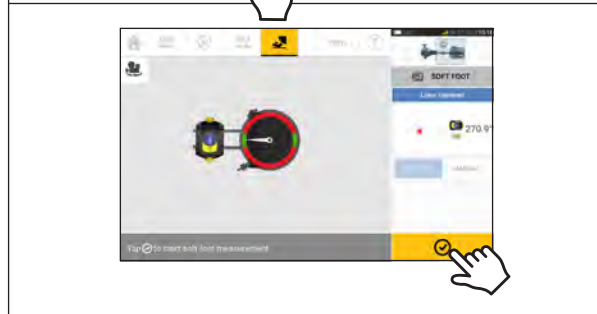
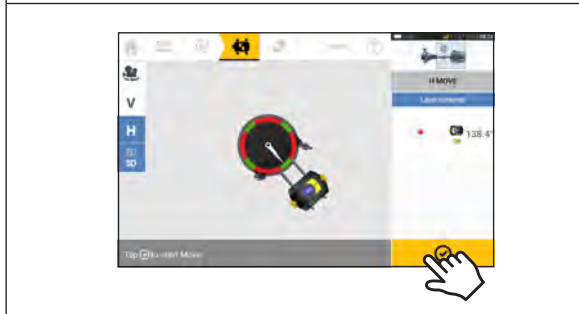



Four sequential screenshots of a mobile application interface, each with a hand cursor icon pointing to a specific element.

- Top Screenshot:** Shows a measurement tool interface with a camera view of a part. A hand cursor points to the 'RESULTS' button on the right. A table of data is visible:

0.01	0.00
0.02	0.04
0.07	0.12
- Second Screenshot:** Shows a form titled 'ACME ZID' with a keyboard overlay. A hand cursor points to the keyboard area.
- Third Screenshot:** Shows a document view with a PDF icon and the Adobe logo. A hand cursor points to the PDF icon.
- Bottom Screenshot:** Shows a 'Machine properties' screen with a question mark icon in the top left. A hand cursor points to the bottom right area.



1 

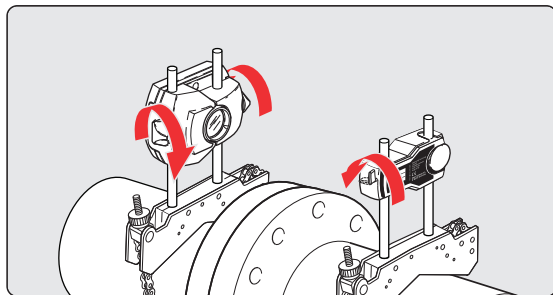
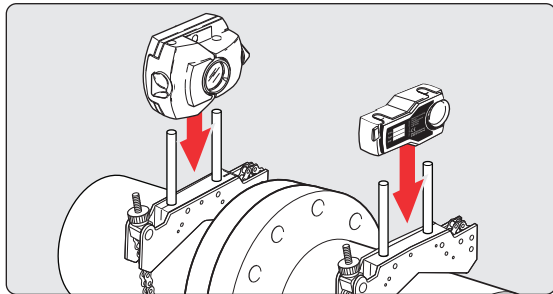
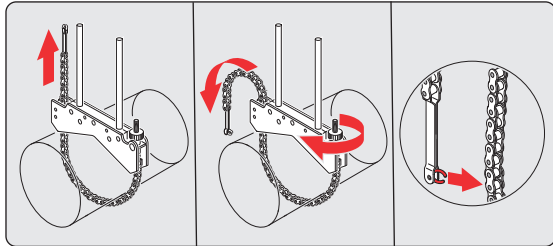

2 

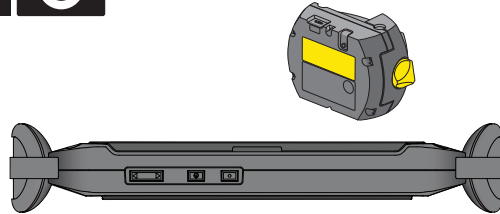

3 

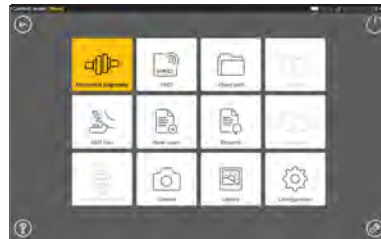



4 **DIM** 



5 

Hand icons on the left side of the page indicate touch points for the screenshots.

6 **RES** 

	/100 mm		/10"	
	OK (mm)	⚠ (mm)	OK (mil)	⚠ (mil)
600	0.15	0.10	14.9	10.0
750	0.12	0.08	12.3	8.2
900	0.10	0.07	10.5	7.0
1000	0.10	0.06	9.6	6.4
1200	0.08	0.05	8.2	5.4
1500	0.07	0.04	6.7	4.5
1800	0.06	0.04	5.7	3.8
3000	0.04	0.02	3.7	2.5
3600	0.03	0.02	3.1	2.1
6000	0.02	0.01	2.0	1.3
7200	0.02	0.01	1.7	1.1

	OK (mm)	⚠ (mm)	OK (mil)	⚠ (mil)
600	0.23	0.13	9.0	5.1
750	0.18	0.10	7.3	4.1
900	0.16	0.09	6.1	3.4
1000	0.14	0.08	5.5	3.1
1200	0.12	0.07	4.6	2.6
1500	0.09	0.05	3.7	2.1
1800	0.08	0.04	3.1	1.8
3000	0.05	0.03	1.9	1.1
3600	0.04	0.02	1.6	0.9
6000	0.02	0.01	1.0	0.6
7200	0.02	0.01	0.8	0.5

Hand icons on the left side of the page indicate touch points for the screenshots.